

SOPORTES DE BARRA CU TIPO ESCALA

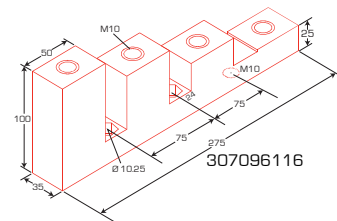

Características técnicas

- Soportes tipo escala.
- Material: Resina poliéster reforzado de alto grado, DMC.
- Material inserto: Bronce o acero níquelado.
- Rigidez Dieléctrica: 10 kV/mm.
- Color: Rojo.
- Certificado UL: QMFZ2.E249670 - QMFZ8.E249670.

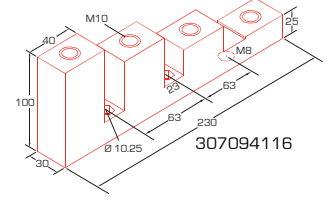
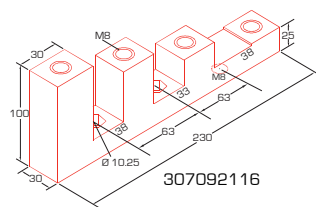
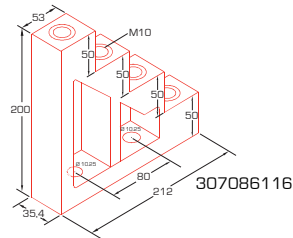
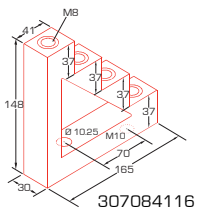
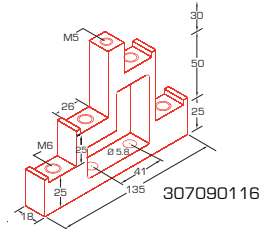
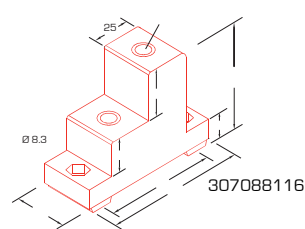
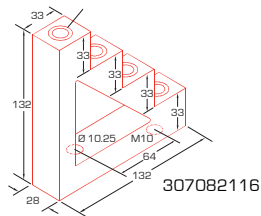
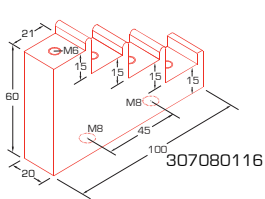

| CÓDIGO DARTEL | DESCRIPCIÓN |
|---------------|--|
| 307080116 | SOPORTE BARRA ESCALA 4AT20 4PS 10KV/MM |
| 307082116 | SOPORTE BARRA ESCALA 4AT30 4PS 10KV/MM |
| 307084116 | SOPORTE BARRA ESCALA 4AT40 4PS 10KV/MM |
| 307086116 | SOPORTE BARRA ESCALA 4AT50 4PS 10KV/MM |
| 307088116 | SOPORTE BARRA ESCALA 2AT25 2PS 10KV/MM |
| 307090116 | SOPORTE BARRA ESCALA 5AT25 2PS 10KV/MM |
| 307092116 | SOPORTE BARRA ESCALA 4BT30 4PS 10KV/MM |
| 307094116 | SOPORTE BARRA ESCALA 4BT40 4PS 10KV/MM |
| 307096116 | SOPORTE BARRA ESCALA 4BT50 4PS 10KV/MM |

| DIMENSIONES | | | | | | | | | | | | | | |
|-------------|-----|------|----|----|----|--------|-----|-----|----|----|----|----|----|----|
| A | B | C | D | E | F | G | H | I | I1 | F1 | F2 | F3 | F4 | F5 |
| 60 | 100 | 20 | 21 | 45 | 15 | - | M8 | M6 | - | - | - | - | - | - |
| 132 | 132 | 28 | 33 | 64 | 33 | Ø10.25 | M10 | M8 | - | - | - | - | - | - |
| 148 | 165 | 30 | 41 | 70 | 37 | Ø10.25 | M10 | M8 | - | - | - | - | - | - |
| 200 | 212 | 35.4 | 53 | 80 | 50 | Ø10.25 | - | M10 | - | - | - | - | - | - |
| 60 | 80 | 30 | 25 | 63 | - | Ø8.3 | - | M8 | - | 11 | 19 | 27 | 14 | - |
| 105 | 135 | 18 | 26 | 41 | - | Ø5.8 | - | M5 | M6 | 25 | 25 | 55 | 30 | 50 |
| 100 | 230 | 30 | 30 | 63 | 25 | Ø10.25 | - | M8 | - | - | - | - | - | - |
| 100 | 230 | 30 | 40 | 63 | 25 | Ø10.25 | M8 | M10 | - | - | - | - | - | - |
| 100 | 275 | 35 | 50 | 75 | 25 | Ø10.25 | M10 | M10 | - | - | - | - | - | - |